

Monday 25th January 2021 – Geography

Year 2 focus for the rest of the Term 3

Locality

Name & locate the world's 7 continents and 5 oceans

Place knowledge

Understand geographical similarities and differences through studying the human and physical geography of a small area of the United Kingdom, and of a small area in a contrasting non-European country

Human and physical geography

Identify seasonal and daily weather patterns in the United Kingdom and the location of hot and cold areas of the world in relation to the Equator and the North and South Poles

Key Vocabulary for this week.

Europe

South America

North America

Africa

Asia

Australasia

Antarctica

Capital Cities

United Kingdom

Weather

Windy

Rain

Sunny

Sleet

Snow

Dry

Foggy

Misty

Task 1: Read and understand the world map

Task 2: Complete the 2DO on Purple Mash about labelling the Continents.

Extension: Why is the Arctic not a continent? Research using

<https://www.kiddle.co/>.

Continents and Oceans



Tuesday 26th January 2021 – Geography

Fact File about France



Task 1: Read the facts about France, a country in Europe

Task 2: Complete the 2DO on Purple Mash about creating a Fact File about France

Extension: Choose another country in Europe and present your work as an advert to visit the country.

<https://www.kiddle.co/>.

Key Vocabulary for this week.

Europe

South America

North America

Africa

Asia

Australasia

Antarctica

Capital Cities

United Kingdom

Weather

Windy

Rain

Sunny

Sleet

Snow

Dry

Foggy

Misty

France

Population: Over 62.2 million (2018)

Capital City: Paris

Languages: French is the language spoken by 88% of the population. Other languages spoken are English, Spanish, Portuguese, German, Italian and Arabic.

Continent: Europe

Currency: Euro

Mountain Ranges: The French Alps, the Massif Central, the Jura and the Pyrenees

Major Rivers: The Loire, the Rhone and the Seine

Government: The Government of the French Republic

National Day: La Fête nationale (The National Celebration – commonly referred to as Bastille Day) 14th July

Flag:



Religion: 64% Christian (mainly Roman Catholic), others include Islam and Buddhism, with 24% being non-religious.

Famous French Men and Women: Napoleon Bonaparte, French Emperor; Andre the Giant, wrestler and actor; Zinedine Zidane, footballer; Juliette Binoche, actress; Gustave Eiffel, engineer; Claude Monet, artist; Brigitte Bardot, actress; Marie Curie, scientist.

You can find out more through from the National Geographic Kids.

<https://www.natgeokids.com/uk/discover/geography/countries/facts-about-france/>

Wednesday 27th January 2021 – Geography

Map of United Kingdom Locating countries.

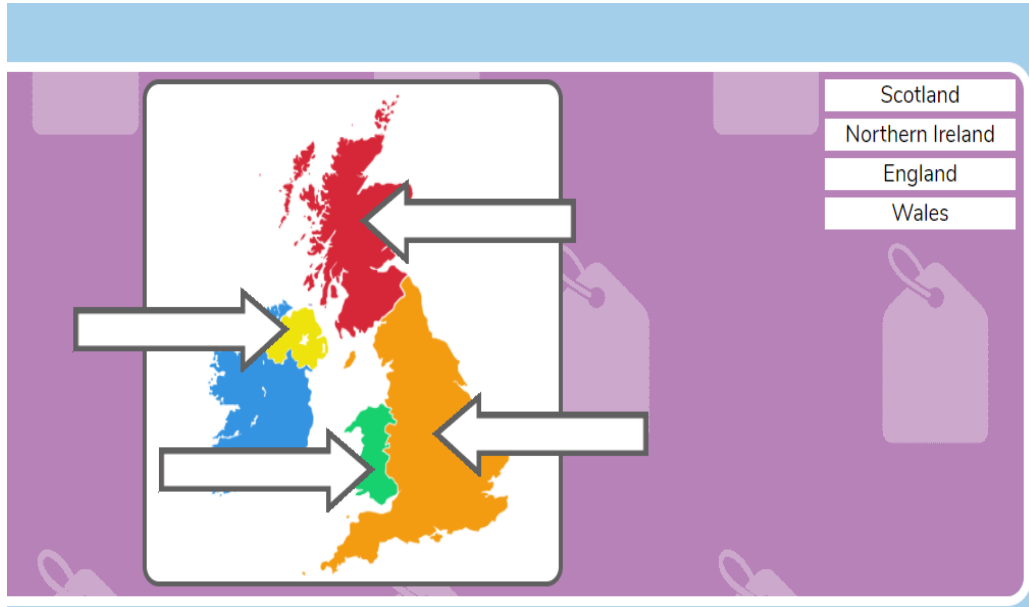

Task 1: Label this 2do map on Purple Mash

Task 2: Print or roughly sketch this map and locate a famous landmark for each country. See the fact sheet and watch clips about each landmark. Upload your photo!

Key Vocabulary for this week.

Europe
South America
North America
Africa
Asia
Australasia
Antarctica
Capital Cities
United Kingdom
Weather
Windy
Rain
Sunny
Sleet
Snow
Dry
Foggy
Misty

United Kingdom

The official name of the UK is 'The United Kingdom of Great Britain and Northern Ireland'.



To help you with Task 2.

UK Landmarks

The UK has some really amazing landmarks. Let's find out about some of them! You may have seen pictures of them. Maybe you've even visited one of these landmarks.

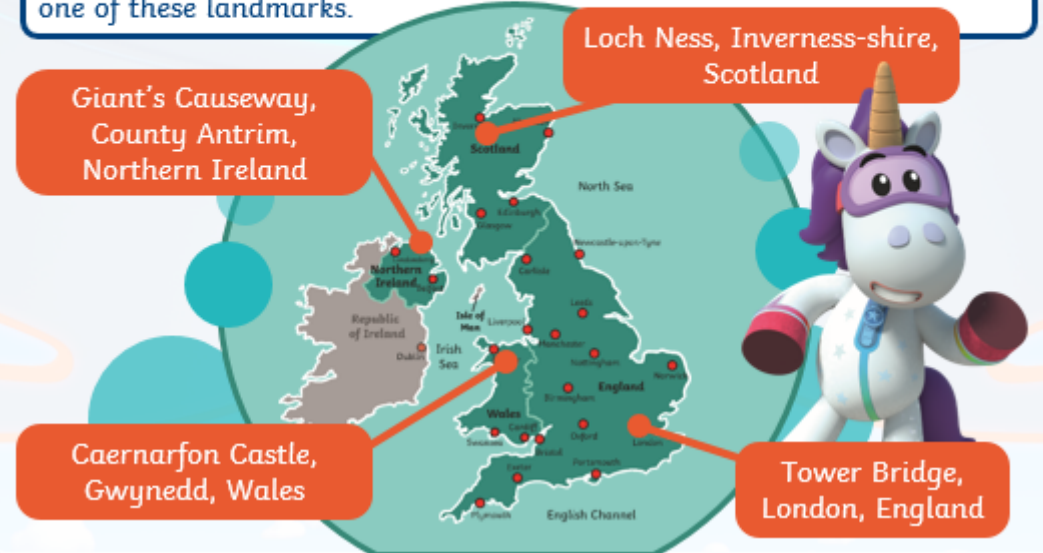

<https://www.bbc.co.uk/teach/class-clips-video/pshe-eyfs-ks1-go-jettters-uk-places-and-landmarks/zkyjkmn>

Thursday 28th January 2021 – Geography

Locate capital cities and cities in UK

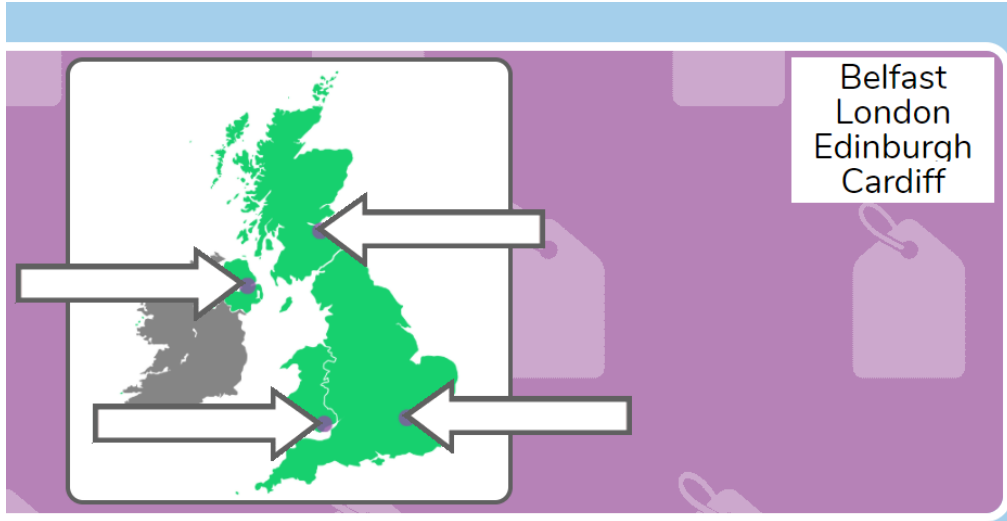

Task 1: Read and understand the map of UK (next slide)

Task 2: Complete this 2do on labelling the capital cities in UK.

Task 3: Complete this 2do on labelling the cities in UK.

Extension: Create a poster about Coxheath. Where is Coxheath located? In which country?

In which city? Is Coxheath a village or town. What are the seasons like? Are there any landmarks in or near Coxheath?

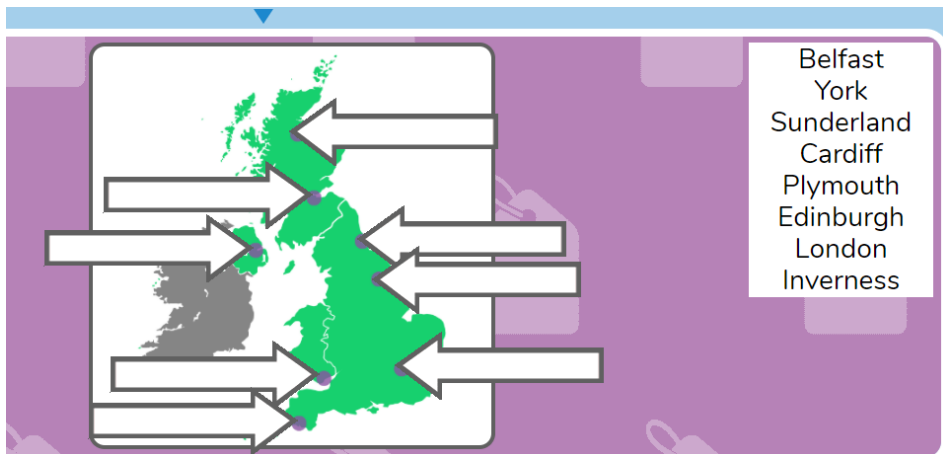

Key Vocabulary for this week.

Europe

South America

North America

Africa

Asia

Australasia

Antarctica

Capital Cities

United Kingdom

Weather

Windy

Rain

Sunny

Sleet

Snow

Dry

Foggy

Misty



Make sure you visit this map on
<http://ontheworldmap.com/uk/united-kingdom-map-1500.jpg>

First and click to zoom in to see more clearly.
Then you will be able to complete your
Purple Mash task more accurately.

Friday 29th January 2021 – Geography

Locate capital cities and cities in UK

Task 1:

Visit the MET office official website for today here. (We will show on you on our Zoom call.

<https://www.metoffice.gov.uk/public/weather/forecast/map#?map=SignificantWeather&zoom=5&lon=-4.00&lat=55.01&fcTime=1611284400>

Using information from here create your own weather report for today on Purple Mash as below. Make sure read about the symbols.

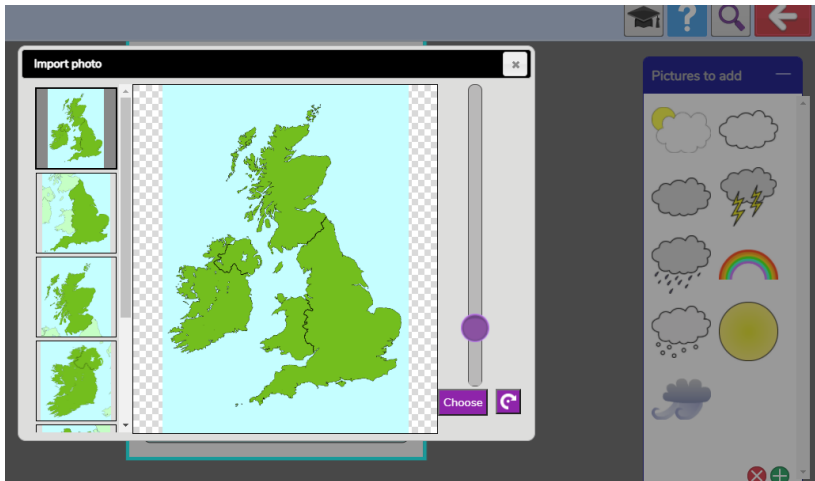

Extension

You have set you a 2do for you to complete for 6 days, from Saturday- Thursday too.

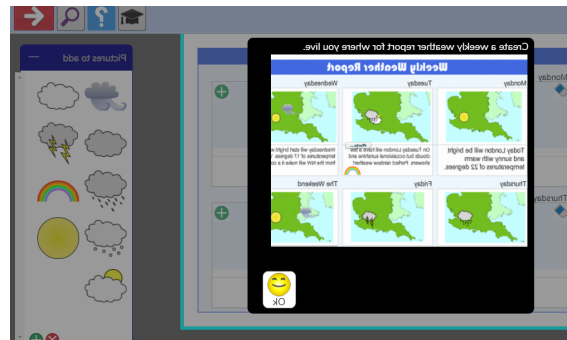

Key Vocabulary for this week.

Europe

South America

North America

Africa

Asia

Australasia

Antarctica

Capital Cities

United Kingdom

Weather

Windy

Rain

Sunny

Sleet

Snow

Dry

Foggy

Misty