

Document is now uploaded. In this example it is in a shared folder.

The screenshot shows the Purple Mash interface. At the top, there's a navigation bar with icons for Home, 2Dos, Work, Data, Sharing, Teachers, Admin, and Help. The user 'John Zsimple' is logged in. The main area displays a folder structure on the left: My Work, Class, Class 1, Pupils, Work to do at home (selected), 2dos, Class 3A, Class 3CP, Class 4P, Class 5A, Class 5B, Unassigned, Group, School, and Staff. The right pane shows a table of documents. The first document is 'Long-Multiplication--Formal-Method.ppt', uploaded by 'G G' on 'Thu, 19 Mar 2020 13:35'. It has a 'Save' button and a 'None' rating.

Pupils uploading documents

The screenshot shows the Purple Mash interface from a pupil's perspective. The user 'Aadhya Krishnan Zsimple' is logged in. The main area displays a folder structure on the left: My Work, Class, Class 1, Work to do at home (selected), Group, and School. The right pane shows a table of documents. The first document is 'Long-Multiplication--Formal-Method.ppt', uploaded by 'G G' on 'Thu, 19 Mar 2020 13:35'. It has a 'Save' button and a 'None' rating.

- Pupils can now access the document in either their 'My work' or in the 'shared folder', this depends on the location that the teacher has saved it in. The pupil can open this file to work on it.
- Pupils can now save that document and upload it back into their 'My Work' folder.

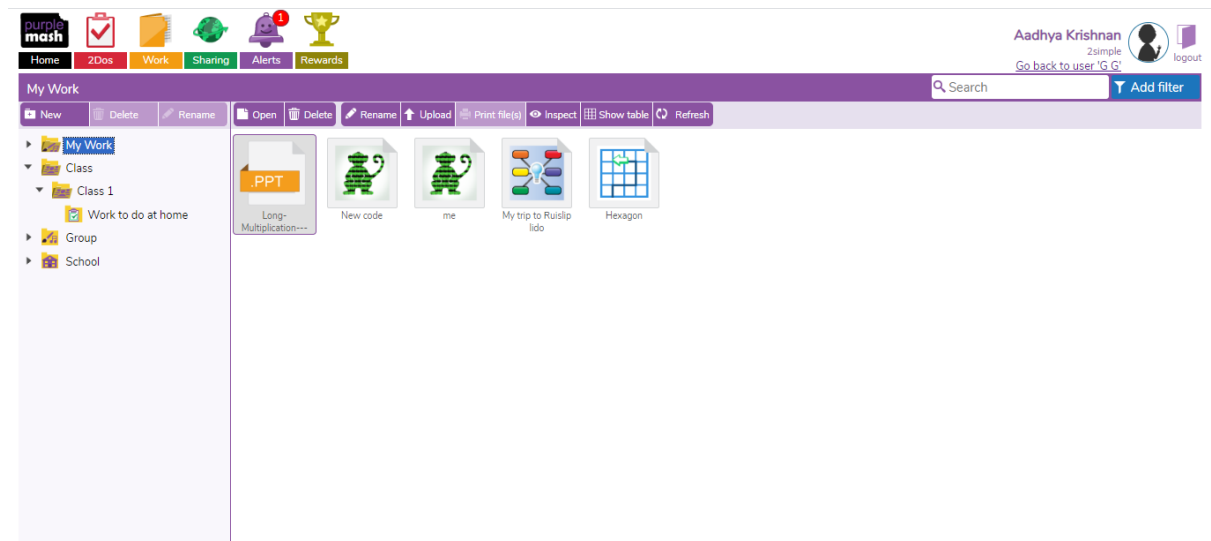
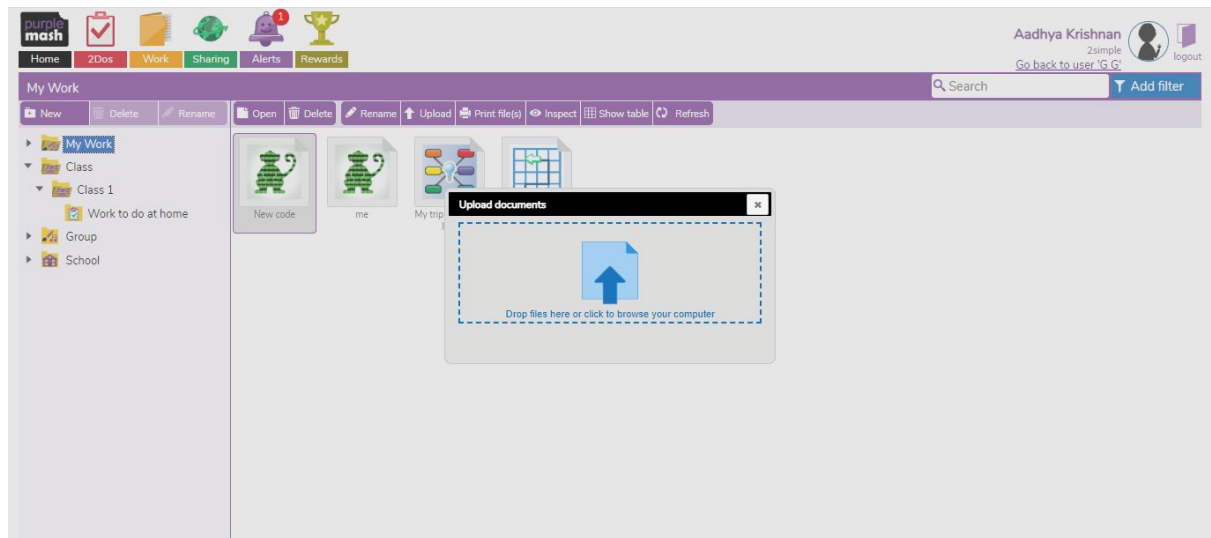

Teacher can now view the completed document in the pupils 'My Work' folder.

